



HAMMERHEAD®
CLEANING EQUIPMENT COMPANY

950MS

User Manual



ENGINEERED SIMPLICITY™

Easy to Use
Efficient
Economical

HammerheadClean.com



EXPLODED VIEW OF MACHINE

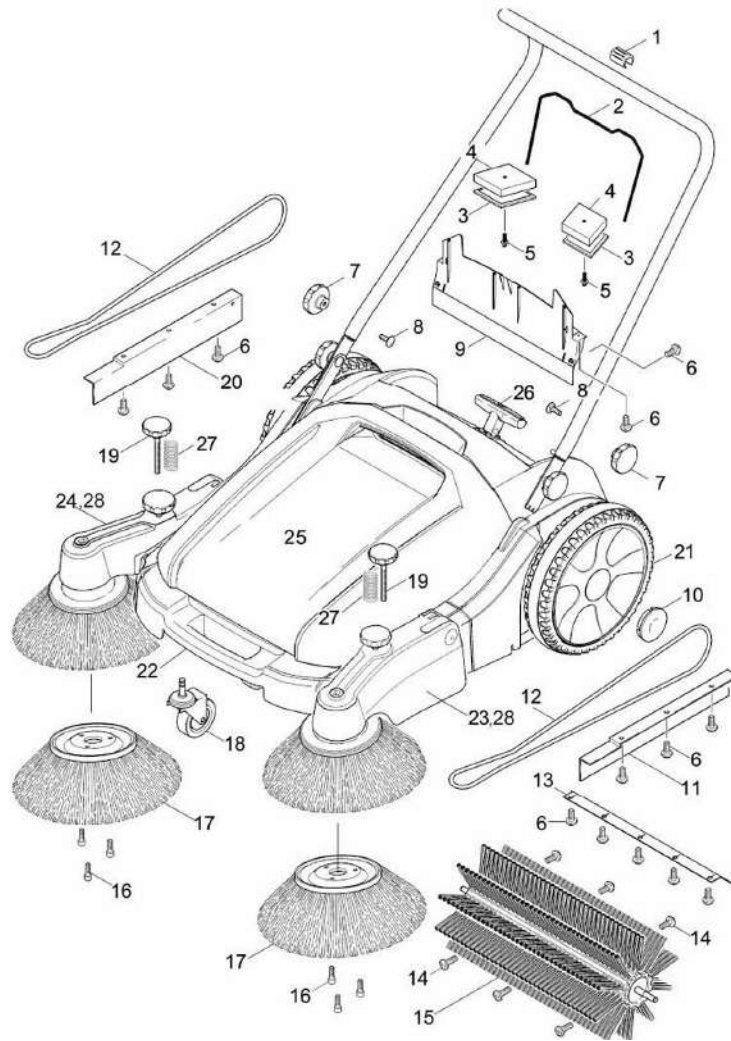

- | | |
|------------------------|----------------------------|
| 1. Clamp | 15. Rolling brush complete |
| 2. Seal rubber | 16. Screw |
| 3. Filter covering cap | 17. Side brush |
| 4. Filter | 18. Castor |
| 5. Plug | 19. Turning knob |
| 6. Screw | 20. Skirting 2 |
| 7. Turning knob | 21. Wheel |
| 8. Saucer-head screw | 22. Frame |
| 9. Rear Skirting | 23. Arm right |
| 10. Wheel cap | 24. Arm left |
| 11. Skirting 1 | 25. Debris container |
| 12. Round belt | 26. Adjusting lever |
| 13. Ground lip | 27. Spring for side brush |
| 14. Screw | 28. Pulley block |

TECHNICAL DESCRIPTION	U/M	950MS
Working width with two side brushes	in	36
Container Capacity	gal	10.5
Maximum Theoretical Area Performance	ft ² /hr	39,611
Net weight	lbs	52.5
Dimension	in	51x31x41
Dimension (folded)	in	35x31x15



STANDARD PRODUCTS AND SPARE PARTS IN THE BOX



Sweeper Body

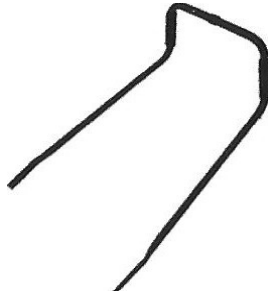

Handle- 1 Pc

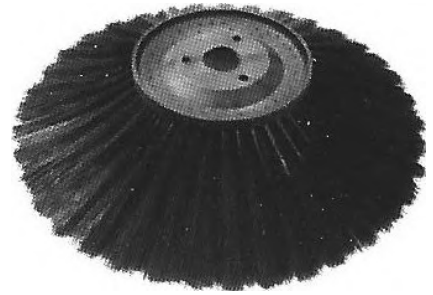

Front Brush- 2 Pcs



Turning Knob - 2 Pcs

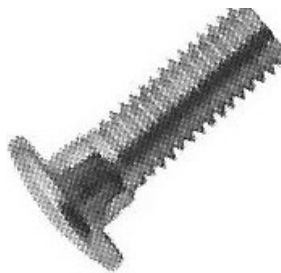

Bolt- 2 Pcs



Screw- 6 Pcs



Wrench



Phillips Screwdriver

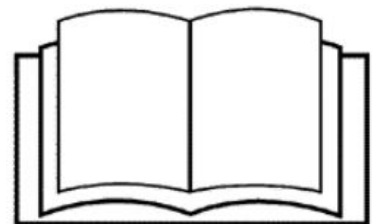

Instruction Manual



NOTE

1. This unit is designed for outdoor and hard flooring. Home carpet may not be suitable for use with this machine.
2. Before use, make sure the unit is in good and safe working condition.
3. The sweeper is not suitable for sweeping up liquids. Do not sweep up burning or glowing objects (e.g. cigarettes, matches or similar).
4. Heavy stones and large size debris may be unable to be collected.
5. Please lift the two side brushes when cleaning high levels of dust.
6. Please avoid sweeping up long rope or like material to avoid brushes tangling and being damaged. If this happens, remove by reversing the roller brush (see image below).

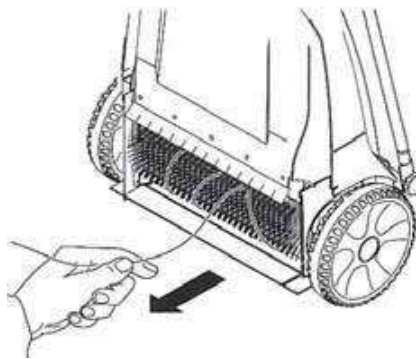

SAFETY WARNING!

1. When sweeping and operating the machine in front of children, please be extremely careful and remain aware of your surroundings.
2. Please do not use the unit as a toy for children.
3. Please do not let your hair, feet, clothes, etc. of your body get caught in the garbage collecting mouth of the unit.
4. Please do not operate the sweeper barefoot or wearing footwear that exposes your feet.
5. Please do not sweep hot, burning or smoking debris in order to avoid any fire hazard or personal injury.
6. Please do not collect flammable and explosive or poisonous material.
7. When collecting any shards of glass or other sharp and potentially hazardous materials, please wear safety gloves.
8. Please do not operate and store the unit close to heating source.
9. Please store the unit in a safe place to avoid any unintentional damage.
10. Please use sturdy gloves when removing glass, metal or other materials from the dirt container.



HOW TO USE

1. Take out the brushes from the debris container and screw on the brushes.

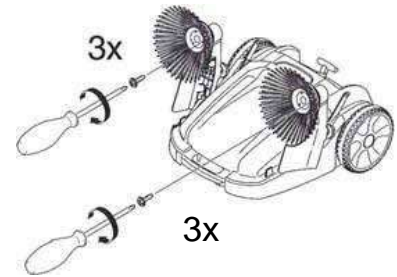

2. Remaining screws are used with the knobs to adjust the handle.

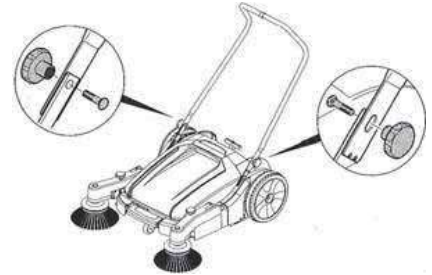

3. Three- position adjustable handle is in place for maximum operator comfort and convenience.

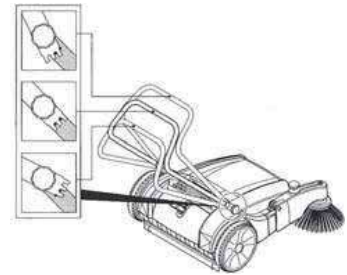

4. Adjustable roller broom height with 6 different positions.

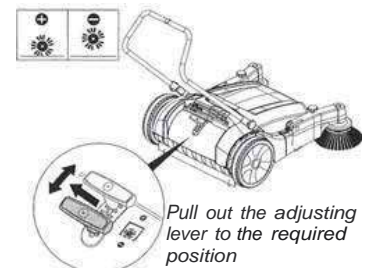

5. Easy to adjust front brush pressure for outstanding sweeping performance.



6. Adjustable side broom swings out of the way when use is not required.

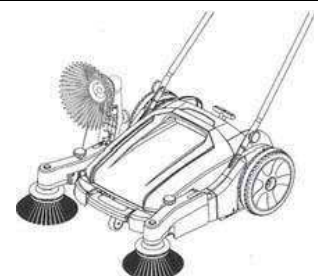



EMPTY THE HOPPER AND HOW TO REMOVE COMPONENTS

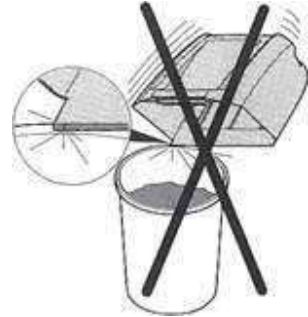
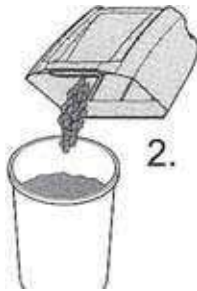
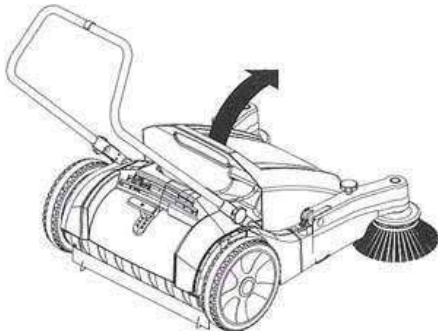

1. Lift the debris container handle and detach the hopper.
2. Collect the hopper and empty in the appropriate waste container.*

*NOTE: DO NOT POUND HOPPER AGAINST WASTE RECEPTACLE. Doing so may result in damage to the hopper or the receptacle.

GROUND LIP

Unscrew all retaining screws.
The ground lip can then be taken out.

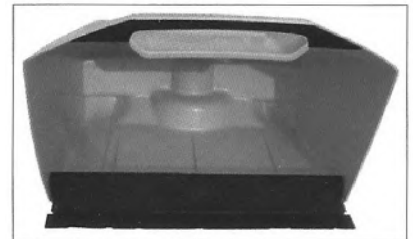

REAR SKIRTING

Unscrew all retaining screws.
The rear skirting can then be taken out.



SKIRTING

Unscrew all retaining screws.
The rear can then be taken out.

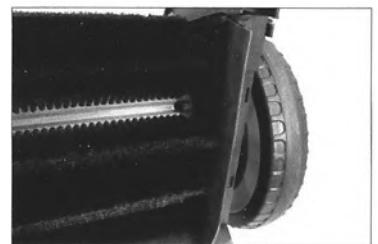

MAINTENANCE

1. The broom can be cleaned with water. Avoid using hot water or heat air blowing.
2. Sweeper body can be cleaned with water. Avoid having it in direct sunlight for long periods of time.
3. Spool cords and threads must be removed for best results.

As this machine is used regularly, ensure you tighten, every now and then, the front caster (shown) with our specially-made wrench (included with machine). Avoid having looseness in the wheel or worse, have it fall off while in operation.





WHEEL

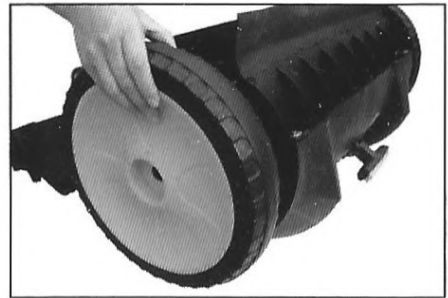
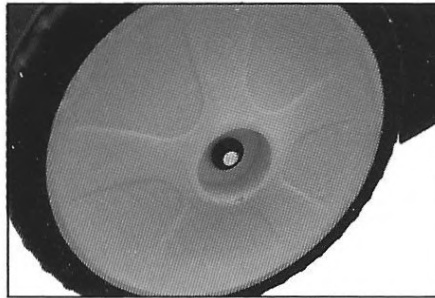
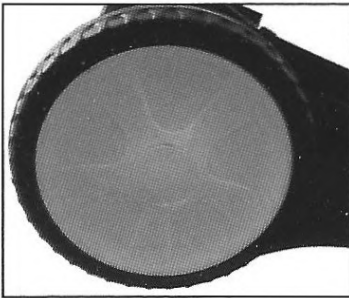

1. Use a screwdriver to un-clip the cap cover in the middle of the wheel.
2. Use wire cutting pliers to disconnect and remove the lock washer.
3. The lock washer is broken when removed. A new lock washer must be used to reinstall the wheel.
4. The wheel can be pulled off the axle.

ROUND BELT

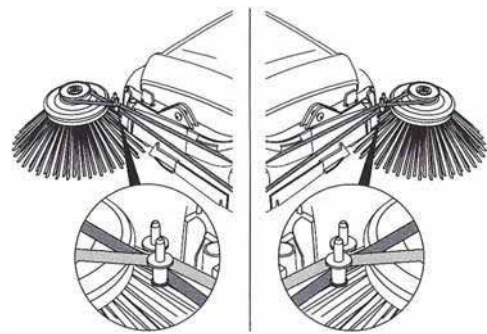

When installing the drive belt, pay attention to the rotational direction of the side brush. When moving forward, the side brush must rotate towards the inside.

OPERATION

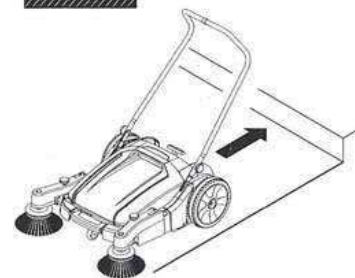
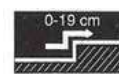

1. Hand push action. Extremely easy to use. Normal walking speed is recommended.
2. Ideal for cleaning paths, halls, sidewalks and warehouses quickly and conveniently.
3. Suitable for fine dust and small pieces, like sand, grain, nails, bolts, sawdust and papers.
4. The cleaning surface should be completely flat or a height difference of $\leq 2.5\text{cm}$. Walking the step in the opposite direction $\leq 19\text{cm}$.



STORAGE

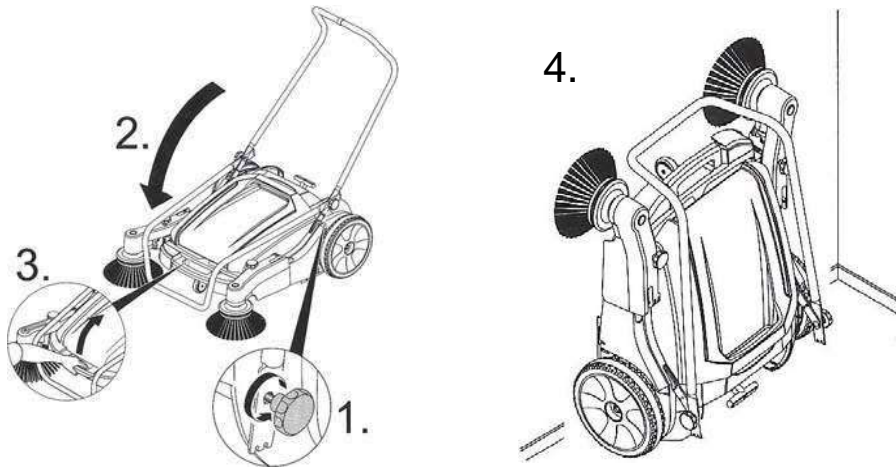

Space Saving Storage.
Folds completely for convenient storage.

PROBLEM TREATMENT

Fault	Solution
Unsatisfactory Sweeping Results	Empty debris container. Adjust height of the main broom/clean/replace. Adjust height of the side brushes and clean/replace. Check/replace the drive belt for side brush.

PARTS REPLACEMENT

MAIN BRUSH

1. To dismantle the main brush, unscrew all (6-9) retaining screws.
2. The two main brush half-shells can then be taken out.



FINE FILTER CLEAN AND REPLACEMENT

Pull out the retaining pin and remove the filter for cleaning or replacement.

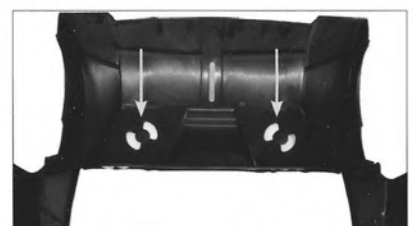
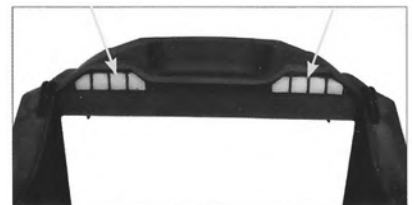
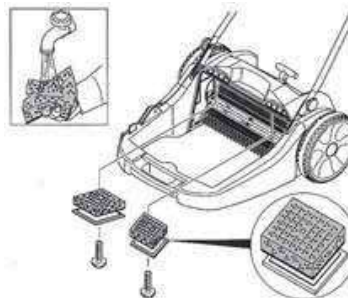



950MS Specs and NOTES

MODEL 950MS

WEIGHT 23.8kg

BATTERIES None

DRIVE Manual forward and reverse belt drive system

WORK RATING 3,680 square meters per hour

MAINBROOM PATH 920mm

MAX. GRADIENT N/A

SPEED Manual

CAPACITY 40L

SWEEPING SYSTEM Double round brush, and one roller brush

DIMENSIONS 1300X790X1035mm

SAVE ROOM Can be folded

PACKAGE CARTON

PACKAGE DIMENSIONS 890X810X400mm

APPLICATION Indoor, Outdoor

ENGINEERED SIMPLICITY™



CONTACT US

info@hammerheadclean.com
HammerheadClean.com